



PATTERSON SERVICES, INC.

BOP Information Sheet*

Cameron U BOP Double 13-5/8" 10K

Tubing

1" thru 4 1/2"

Drill Pipe

2 3/8" thru 5 1/2"

Heavy Weight

Drill Pipe

2 7/8" thru

6 5/8"

Drill Collars

2 7/8" thru 10"

Blow-Out

Preventers

Annular Type

2 9/16" 5M thru

29 1/2" 500 PSI

Hydraulic Ram

Type

Single and Double

3 1/16" 10M thru

21 3/4" 5M

Valves Manual &

Hydraulic

12" Ball Valves

2 1/16" 5M thru

4 1/16" 15M

1	BOP Serial #	P-
2	Type	Type "U" Double Ram BOP 13-5/8" 10K
3	Manufacturer	Cameron
4	Height	66.625" / 1.692 m
5	Weight (Standard)	18,400 lbs. / 8,346.100 kg
6	Weight (with LBT) (LBT ≤ 1,050 lbs each, 2,100 lbs per pair)	20,500 lbs. / 9,298.644 kg
7	Length (bonnets closed)	114.125" / 2.899 m
8	Length (bonnets opened)	172.750" / 4.388 m
9	Length (bonnets closed, LBT installed) (LBT ≤ 19.750" each, 39.50" per pair)	153.625" / 3.902 m
10	Length (bonnets opened, LBT installed) (LBT ≤ 19.750" each, 39.50" per pair)	212.250" / 5.391 m
11	Bonnet bolt torque (API lube)	14,500 ft.lbs. / 19,659 N'm
12	Bonnet bolt torque (Moly Lube)	7,500 ft.lbs. / 10,169 N'm
13	Bonnet bolt (impact socket size)	3-1/2" / 88.900 mm
14	Bonnet bolt (striking wrench size)	2-1/4" / 57.150 mm
15	Hydraulic operating pressure	1,500 PSI / 103.422 bar
16	Max hydraulic operating pressure	3,000 PSI / 206.844 bar
17	Open and close porting size	1" NPT
18	Open volume/Standard Bonnet per cavity	5.5 gal. / 20.820 liters
19	Close volume/Standard Bonnet per Cavity	5.8 gal. / 21.955 liters
20	Open volume (with LBT installed)	10.5 gal. / 39.747 liters
21	Close volume (with LBT installed)	17.5 gal. / 66.245 liters
22	Ram Change rod open faced wrench size	2-1/4" / 57.150 mm
23	(2) 13-5/8" 10K Flange-Bolt Diameter x Length	1-7/8" x 17-3/4" / 47.625 mm x 450.850 mm
24	Quantity	20 per flange
25	Bolt Torque	3,332 ft.lbs. / 4,517.526 N'm
26	(4) 4-1/16" 10K Flange Outlet-Bolt Diameter x Length	1-1/8" x 8-1/2" / 28.575 mm x 215.900 mm
27	Quantity	8 per flange
28	Bolt Torque	686 ft.lbs. / 930 N'm
29	Flange Gasket	BX-159
30	Outlet Gasket	BX-155

* Drawings and information contained herein are for general purposes and are for reference only. Dimensions may vary according to Manufacturer, Year Manufactured, Model or Type.

Technical information contained herein is furnished without charge or obligation and is given and accepted at recipient's sole risk. Because conditions of use may vary and are beyond our control, Patterson Services, Inc. makes no representation about, and is not responsible or liable for the accuracy or reliability of the data, described herein. Nothing contained in this document shall be considered a recommendation for any use that may infringe patent rights, or an endorsement of any particular material, equipment, service, or other item. The properties listed in this document are not specification. They are provided as information only and in no way modify, amend, enlarge or create any specification or warranty.





PATTERSON SERVICES, INC.

SPECIFICATIONS

DIMENSIONAL DATA

Cameron U BOP Double 13-5/8" 10K

Size	Pressure rating (PSI)	Vertical Bore (inches)
13.625"	10,000	13.625"

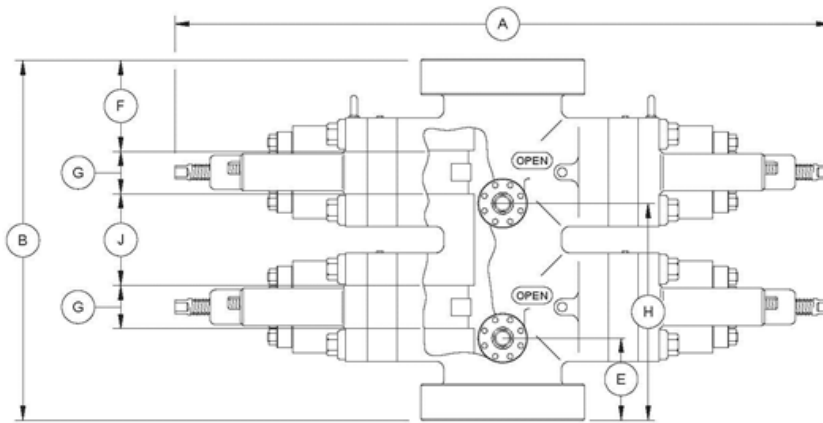
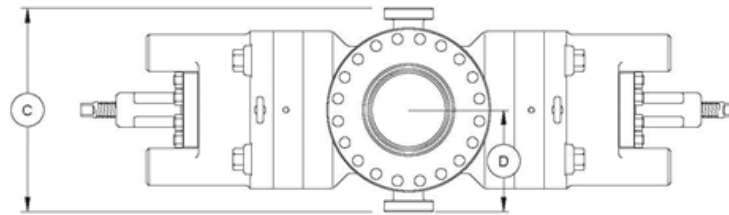

Double U BOP

The capital letters in the following designations refer to the U BOP dimensional views and dimensional charts shown.

- A-1 Length - bonnets closed, locking screws locked
- A-2 Length - bonnets opened, locking screws unlocked .
- A-3 Length - bonnets closed, with wedgelocks
- A-4 Length - bonnets opened, with wedgelocks
- B-1 Height - flanged
- B-2 Height - clamp hubs
- C Width - no side outlets
- D Centerline of preventer to outlet flange or hub face. *This distance is variable and must be determined per individual specifications.*
- E-1 Centerline of side outlet below rams to bottom flange face
- E-2 Centerline of side outlet below rams to bottom hub face
- F-1 Top of upper ram to top flange face
- F-2 Top of upper ram to top hub face
- G Height of ram
- H-1 Centerline of side outlet between rams to bottom flange face
- H-2 Centerline of side outlet between rams to bottom hub face
- J Top of lower ram to bottom of upper ram

English Units (inches)

A-1	A-2	A-3	A-4	B-1	B-2	C	E-1	E-2	F-1	F-2	G	H-1	H-2	J	English Units (lb) Approx. Weight (lb)
114.125	172.750	124.688	167.312	66.625	57.750	30.250	15.125	10.688	17.094	12.656	7.500	40.062	35.625	17.438	18,400.00

Metric Units (m)

A-1	A-2	A-3	A-4	B-1	B-2	C	E-1	E-2	F-1	F-2	G	H-1	H-2	J	Metric Units (kg) Approx. Weight (kg)
2.899	4.388	3.167	4.250	1.692	1.467	768.350	384.175	271.475	434.188	321.462	190.500	1,017.575	904.875	442.925	8,346.10

Tubing

1" thru 4 1/2"

Drill Pipe

2 3/8" thru 5 1/2"

Heavy Weight Drill Pipe

2 7/8" thru 6 5/8"

Drill Collars

2 7/8" thru 10"

Blow-Out Preventers

Annular Type

2 9/16" 5M thru 29 1/2" 500 PSI

Hydraulic Ram Type

Single and Double

3 1/16" 10M thru 21 3/4" 5M

Valves Manual & Hydraulic

12" Ball Valves

2 1/16" 5M thru 4 1/16" 15M