



PATTERSON SERVICES, INC.

BOP Information Sheet*

CAMERON U BOP Single 7-1/16" 10K

Tubing

1" thru 4 1/2"

Drill Pipe

2 3/8" thru 5 1/2"

Heavy Weight

Drill Pipe

2 7/8" thru

6 5/8"

Drill Collars

2 7/8" thru 10"

Blow-Out

Preventers

Annular Type

2 9/16" 5M thru

29 1/2" 500 PSI

Hydraulic Ram

Type

Single and Double

3 1/16" 10M thru

21 3/4" 5M

Valves Manual &

Hydraulic

12" Ball Valves

2 1/16" 5M thru

4 1/16" 15M

1	BOP Serial #	P-
2	Type	Type "U" Single Ram BOP 7-1/16" 10K
3	Manufacturer	Cameron
4	Height	30.562" / .776 m (776.274 mm)
5	Weight (Standard)	3,550 lbs. / 1,610.253 kilograms
6	Weight (with LBT) (LBT = 290 lbs. each, 580 lbs per pair)	4,130 lbs. / 1,873.336 kilograms
7	Length (bonnets closed)	74.00" / 1.879 m
8	Length (bonnets opened)	109.500" / 2.781 m
9	Length (bonnets closed, LBT installed) (LBT ≤ 15" each, 30" per pair)	≤ 104.000" / 2.641 m
10	Length (bonnets opened, LBT installed) (LBT ≤ 15" each, 30" per pair)	≤ 139.500" / 3.543 m
11	Bonnet bolt torque (API lube)	4,200 ft.lbs. / 5,694 N'm
12	Bonnet bolt torque (Moly Lube)	2,300 ft.lbs. / 3,118 N'm
13	Bonnet bolt (impact socket size)	2-3/4" / 69.85 mm
14	Bonnet bolt (striking wrench size)	1-3/4" / 44.45 mm
15	Hydraulic operating pressure	1,500 PSI / 103.422 bar
16	Max hydraulic pressure	3,000 PSI / 206.844 bar
17	Open and close porting size	1" NPT
18	Open volume w/ standard bonnets	1.3 gal. / 4.921 liters (per set of rams)
19	Close volume w/ standard bonnets	1.3 gal. / 4.921 liters (per set of rams)
20	Open volume (with LBT installed)	2.4 gal. / 9.084 liters
21	Close volume (with LBT installed)	4.2 gal. / 15.898 liters
22	Ram Change rod open faced wrench size	1-3/4" / 44.45 mm
23	(2) 7-1/16" 10K Flange-Bolt Diameter x Length	1-1/2" x 11-3/4" / 38.1mm x 298.45mm
24	Quantity	12 per flange
25	Bolt Torque	1,677 ft.lbs. / 2,274 N'm
26	(2) 2-1/16" 10K Flange Outlet-Bolt Diameter x Length	3/4" x 5-1/2 in. / 19.05 mm x 139.7 mm
27	Quantity	8 per flange
28	Bolt Torque	200 ft.lbs. / 271 N'm
29	Flange Gasket	BX-156
30	Outlet Gasket	BX-152

* Drawings and information contained herein are for general purposes and are for reference only. Dimensions may vary according to Manufacturer, Year Manufactured, Model or Type.

Technical information contained herein is furnished without charge or obligation and is given and accepted at recipient's sole risk. Because conditions of use may vary and are beyond our control, Patterson Services, Inc. makes no representation about, and is not responsible or liable for the accuracy or reliability of the data, described herein. Nothing contained in this document shall be considered a recommendation for any use that may infringe patent rights, or an endorsement of any particular material, equipment, service, or other item. The properties listed in this document are not specification. They are provided as information only and in no way modify, amend, enlarge or create any specification or warranty.





PATTERSON SERVICES, INC.

Tubing
1" thru 4 1/2"

Drill Pipe
2 3/8" thru 5 1/2"

Heavy Weight Drill Pipe
2 7/8" thru 6 5/8"

Drill Collars
2 7/8" thru 10"

Blow-Out Preventers
Annular Type
2 9/16" 5M thru 29 1/2" 500 PSI

Hydraulic Ram Type
Single and Double
3 1/16" 10M thru 21 3/4" 5M

Valves Manual & Hydraulic
12" Ball Valves
2 1/16" 5M thru 4 1/16" 15M

SPECIFICATIONS

DIMENSIONAL DATA

CAMERON U BOP Single 7-1/16" 10K

Size	Pressure rating (PSI)	Vertical Bore (inches)	Single Approx. Weight (lbs)
7 - 1/16"	10,000	7 - 1/16"	3550.000

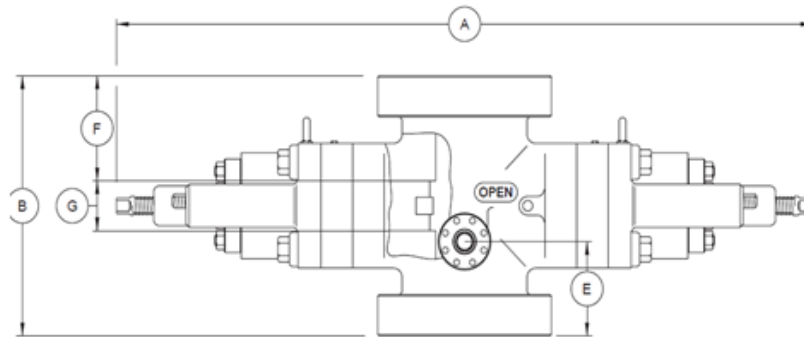
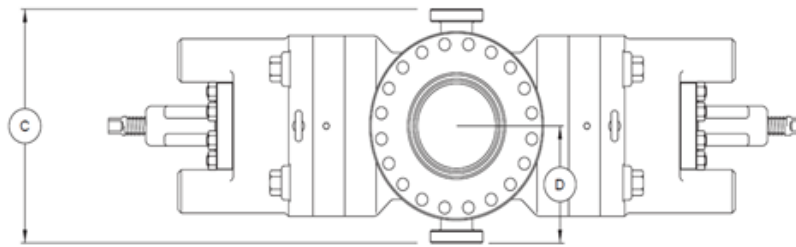

The capital letters in the following designations refer to the U BOP dimensional views and dimensional charts shown.

- A-1 Length - bonnets closed, locking screws locked
- A-2 Length - bonnets opened, locking screws unlocked.
- A-3 Length - bonnets closed, with wedgelocks
- A-4 Length - bonnets opened, with wedgelocks
- B-1 Height - flanged
- B-2 Height - clamp hubs
- C Width - no side outlets
- D Centerline of preventer to outlet flange or hub face.
This distance is variable and must be determined per individual specifications.
- E-1 Centerline of side outlet to bottom flange face
- E-2 Centerline of side outlet to bottom hub face
- F-1 Top of ram to top flange face
- F-2 Top of ram to top hub face
- G Height of ram

Single U BOP

English Units (inches)													(lbs)
A-1	A-2	A-3	A-4	B-1	B-2	C	D	E-1	E-2	F-1	F-2	G	Approx. Weight (lb)
74.000	109.500	-	-	30.562	27.188	20.625	-	11.062	9.375	12.031	10.344	5.500	3,550.000
Metric Units (m)						Metric Units (mm)						Metric Units (kgs)	
A-1	A-2	A-3	A-4	B-1	B-2	C	D	E-1	E-2	F-1	F-2	G	Approx. Weight (kilos)
1.879 m	2.781 m	-	-	0.776	0.690	523.625	-	280.975	238.125	305.587	262.738	139.700	1,610.253