



# PATTERSON SERVICES, INC.

## BOP Information Sheet\*

## Cameron U BOP Single 11" 5K

### Tubing

1" thru 4 1/2"

### Drill Pipe

2 3/8" thru 5 1/2"

### Heavy Weight

### Drill Pipe

2 7/8" thru

6 5/8"

### Drill Collars

2 7/8" thru 10"

### Blow-Out

### Preventers

### Annular Type

2 9/16" 5M thru

29 1/2" 500 PSI

### Hydraulic Ram

### Type

### Single and Double

3 1/16" 10M thru

21 3/4" 5M

### Valves Manual &

### Hydraulic

12" Ball Valves

2 1/16" 5M thru

4 1/16" 15M

1	BOP Serial #	P-
2	Type	Type "U" Single Ram BOP 11" 5K
3	Manufacturer	Cameron
4	Height	34.312" / 871.525 mm (.8715 m)
5	Weight (Standard)	≤ 5,600 lbs. / 2540.117 kilos
6	Weight (with LBT)	N/A
7	Length (bonnets closed)	96.250" / 2.445 m
8	Length (bonnets opened)	146.875" / 3.731 m
9	Length (bonnets closed, LBT installed)	N/A
10	Length (bonnets opened, LBT installed)	N/A
11	Bonnet bolt torque (API lube)	4,200 ft.lbs. / 5694 N'm
12	Bonnet bolt torque (Moly Lube)	2,300 ft.lbs. / 3118 N'm
13	Bonnet bolt (impact socket size)	2-3/4" / 69.850 mm
14	Bonnet bolt (striking wrench size)	1-3/4" / 44.45 mm
15	Hydraulic operating pressure	1500 PSI / 103.422 bar
16	Max hydraulic pressure	3000 PSI / 206.844 bar
17	Open and close porting size	1" NPT
18	Open volume (standard bonnets per cavity)	3.4 gal. / 12.870 liters
19	Close volume (standard bonnets per cavity)	3.5 gal. / 13.25 liters
20	Open volume (with LBT installed)	6.8 gal. / 25.741 liters
21	Close volume (with LBT installed)	12.2 gal. / 46.182 liters
22	Ram Change rod open faced wrench size	2.000" / 50.80 mm
23	(2) 11" 5K Flange-Bolt Diameter x Length	1-7/8" x 14 1/2" / 47.625mm x 368.3 mm
24	Quantity	12 per flange
25	Bolt Torque	3,332 ft.lbs. / 4,517.53 N'm
26	(2) 4-1/16" 5K Outlet-Bolt Diameter x Length	1-1/4" x 8-1/2" / 31.75mm x 215.90mm
27	Quantity	8 per flange
28	Bolt Torque	953 ft.lbs. / 1,292.08 N'm
29	Flange Gasket	R/RX-54
30	Outlet Gasket	R/RX-39

\* Drawings and information contained herein are for general purposes and are for reference only. Dimensions may vary according to Manufacturer, Year Manufactured, Model or Type.

Technical information contained herein is furnished without charge or obligation and is given and accepted at recipient's sole risk. Because conditions of use may vary and are beyond our control, Patterson Services, Inc. makes no representation about, and is not responsible or liable for the accuracy or reliability of the data, described herein. Nothing contained in this document shall be considered a recommendation for any use that may infringe patent rights, or an endorsement of any particular material, equipment, service, or other item. The properties listed in this document are not specification. They are provided as information only and in no way modify, amend, enlarge or create any specification or warranty.





# PATTERSON SERVICES, INC.

- Tubing**  
1" thru 4 1/2"
- Drill Pipe**  
2 3/8" thru 5 1/2"
- Heavy Weight Drill Pipe**  
2 7/8" thru 6 5/8"
- Drill Collars**  
2 7/8" thru 10"
- Blow-Out Preventers**  
Annular Type  
2 9/16" 5M thru 29 1/2" 500 PSI
- Hydraulic Ram Type**  
Single and Double  
3 1/16" 10M thru 21 3/4" 5M
- Valves Manual & Hydraulic**  
12" Ball Valves  
2 1/16" 5M thru 4 1/16" 15M

## SPECIFICATIONS

### DIMENSIONAL DATA

Cameron U BOP Single 11" 5K

Size	Pressure rating (PSI)	Vertical Bore (inches)	Single Approx. Weight (lbs)
11"	5,000	11"	5,600.000

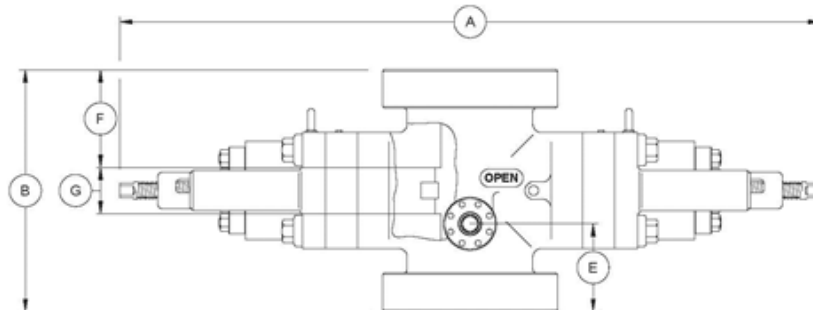
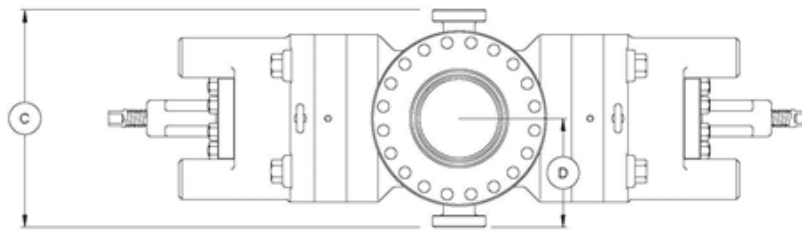

The capital letters in the following designations refer to the U BOP dimensional views and dimensional charts below.

- A-1 Length - bonnets closed, locking screws locked
- A-2 Length - bonnets opened, locking screws unlocked .
- A-3 Length - bonnets closed, with wedgelocks
- A-4 Length - bonnets opened, with wedgelocks
- B-1 Height - flanged
- B-2 Height - clamp hubs
- C Width - no side outlets
- D Centerline of preventer to outlet flange or hub face. *This distance is variable and must be determined per individual specifications.*
- E-1 Centerline of side outlet to bottom flange face
- E-2 Centerline of side outlet to bottom hub face
- F-1 Top of ram to top flange face
- F-2 Top of ram to top hub face
- G Height of ram

#### English Units (inches)

A-1	A-2	A-3	A-4	B-1	B-2	C	D	E-1	E-2	F-1	F-2	G	Approx. Weight (lb)
96.250	146.875	110.125	150.188	34.312	29.312	25.125	-	12.438	9.938	13.156	10.656	6.750	5,600.000

#### Metric Units (m)

Metric Units (m)							Metric Units (mm)					Metric Units (kg)		
A-1	A-2	A-3	A-4	B-1	B-2	C	D	E-1	E-2	F-1	F-2	G	Approx. Weight (kg)	
2.445	3.731	2.797	3.815	0.871	0.744	638.175	-	315.925	252.425	334.162	270.662	171.450	2,540.117	