



# PATTERSON SERVICES, INC.

## BOP Information Sheet\*

## CAMERON U BOP Double 11" 10K

### Tubing

1" thru 4 1/2"

### Drill Pipe

2 3/8" thru 5 1/2"

### Heavy Weight

### Drill Pipe

2 7/8" thru

6 5/8"

### Drill Collars

2 7/8" thru 10"

### Blow-Out

### Preventers

### Annular Type

2 9/16" 5M thru

29 1/2" 500 PSI

### Hydraulic Ram

### Type

### Single and Double

3 1/16" 10M thru

21 3/4" 5M

### Valves Manual &

### Hydraulic

12" Ball Valves

2 1/16" 5M thru

4 1/16" 15M

1	BOP Serial #	P-
2	Type	Type "U" Double Ram BOP 11" 10K
3	Manufacturer	Cameron
4	Height	55.875" / 1.419 m
5	Weight (Standard)	11,300 lbs. / 5,125.594 kg
6	Weight (with LBT) (LBT ≤ 625 lbs each, 1250 lbs per pair)	12,545 lbs. / 5,690.316 kg
7	Length (bonnets opened)	146.875" / 3.731 m
8	Length (bonnets closed)	96.250" / 2.445 m
9	Length (bonnets closed, LBT installed) (LBT ≤ 17" each, 34" per pair)	130.250" / 3.308 m
10	Length (bonnets opened, LBT installed) (LBT ≤ 17" each, 34" per pair)	180.875" / 4.594 m
11	Bonnet bolt torque (API lube)	7,900 ft.lbs. / 10,711 N'm
12	Bonnet bolt torque (Moly Lube)	4,100 ft.lbs. / 5,559 N'm
13	Bonnet bolt (impact socket size)	2-3/4" / 69.850 mm
14	Bonnet bolt (striking wrench size)	1-3/4" / 44.450 mm
15	Hydraulic operating pressure	1,500 PSI / 103.422 bar
16	Max hydraulic pressure	3,000 PSI / 206.844 bar
17	Open and close porting size	1" NPT
18	Open volume/Standard bonnet per cavity	3.4 gal. / 12.870 liters
19	Close volume/Standard bonnet per cavity	3.5 gal. / 13.249 liters
20	Open volume (with LBT installed)	6.8 gal. / 25.741 liters
21	Close volume (with LBT installed)	12.2 gal. / 46.182 liters
22	Ram Change rod open faced wrench size	2.000" / 50.800 mm
23	(2) 11" 10K Flange Bolt Diameter x Length	1-3/4" X 15-3/8" / 44.450 mm x 390.525 mm
24	Quantity	16 per flg.
25	Bolt Torque	2,696 ft.lbs. / 3,655 N'm
26	(4) 4-1/16" 10K Flange Outlet-Bolt Diameter x Length	1-1/8" X 8.5" / 28.575 mm x 215.900 mm
27	Quantity	8 per flg.
28	Bolt Torque	686 ft.lbs. / 930 N'm
29	Flange Gasket	BX-158
30	Outlet Gasket	BX-155

\* Drawings and information contained herein are for general purposes and are for reference only. Dimensions may vary according to Manufacturer, Year Manufactured, Model or Type.

Technical information contained herein is furnished without charge or obligation and is given and accepted at recipient's sole risk. Because conditions of use may vary and are beyond our control, Patterson Services, Inc. makes no representation about, and is not responsible or liable for the accuracy or reliability of the data, described herein. Nothing contained in this document shall be considered a recommendation for any use that may infringe patent rights, or an endorsement of any particular material, equipment, service, or other item. The properties listed in this document are not specification. They are provided as information only and in no way modify, amend, enlarge or create any specification or warranty.





# PATTERSON SERVICES, INC.

**Tubing**  
1" thru 4 1/2"

**Drill Pipe**  
2 3/8" thru 5 1/2"

**Heavy Weight Drill Pipe**  
2 7/8" thru 6 5/8"

**Drill Collars**  
2 7/8" thru 10"

**Blow-Out Preventers**  
**Annular Type**  
2 9/16" 5M thru 29 1/2" 500 PSI

**Hydraulic Ram Type**  
**Single and Double**  
3 1/16" 10M thru 21 3/4" 5M

**Valves Manual & Hydraulic**  
12" Ball Valves  
2 1/16" 5M thru 4 1/16" 15M

## SPECIFICATIONS

### DIMENSIONAL DATA

### CAMERON U BOP Double 11" 10K

Size	Pressure rating (PSI)	Vertical Bore (inches)
11"	10,000	11"

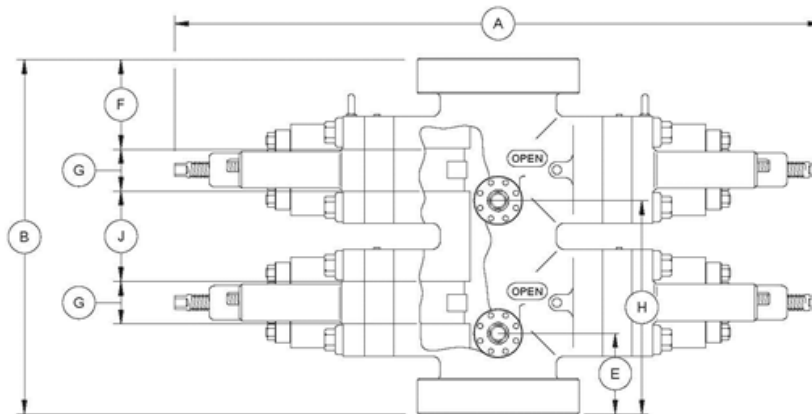
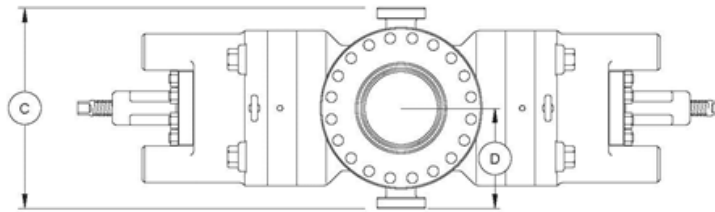

Double U BOP

The capital letters in the following designations refer to the U BOP dimensional views and dimensional charts shown.

- A-1 Length - bonnets closed, locking screws locked
- A-2 Length - bonnets opened, locking screws unlocked.
- A-3 Length - bonnets closed, with wedgelocks
- A-4 Length - bonnets opened, with wedgelocks
- B-1 Height - flanged
- B-2 Height - clamp hubs
- C Width - no side outlets
- D Centerline of preventer to outlet flange or hub face. This distance is **variable** and must be determined per individual specifications.
- E-1 Centerline of side outlet below rams to bottom flange face
- E-2 Centerline of side outlet below rams to bottom hub face
- F-1 Top of upper ram to top flange face
- F-2 Top of upper ram to top hub face
- G Height of ram
- H-1 Centerline of side outlet between rams to bottom flange face
- H-2 Centerline of side outlet between rams to bottom hub face
- J Top of lower ram to bottom of upper ram

#### English Units (inches)

A-1	A-2	A-3	A-4	B-1	B-2	C	E-1	E-2	F-1	F-2	G	H-1	H-2	J	English Units (lb) Approx. Weight (lb)
96.250	146.875	110.125	150.188	55.875	52.375	25.750	13.125	11.375	13.844	12.094	6.750	33.312	31.562	13.438	11,300.00

#### Metric Units (m)

A-1	A-2	A-3	A-4	B-1	B-2	C	E-1	E-2	F-1	F-2	G	H-1	H-2	J	Metric Units (kg) Approx. Weight (kilos)
2.445	3.731	2.797	3.815	1.419	1.330	654.050	333.375	288.925	351.638	307.188	171.450	846.125	801.675	341.325	5,125.594