



PATTERSON SERVICES, INC.

BOP Information Sheet*

Cameron U BOP Single 11" 10K

Tubing

1" thru 4 1/2"

Drill Pipe

2 3/8" thru 5 1/2"

Heavy Weight

Drill Pipe

2 7/8" thru

6 5/8"

Drill Collars

2 7/8" thru 10"

Blow-Out

Preventers

Annular Type

2 9/16" 5M thru

29 1/2" 500 PSI

Hydraulic Ram

Type

Single and Double

3 1/16" 10M thru

21 3/4" 5M

Valves Manual &

Hydraulic

12" Ball Valves

2 1/16" 5M thru

4 1/16" 15M

1	BOP Serial #	P-
2	Type	Type "U" Single Ram BOP 11" 10K
3	Manufacturer	Cameron
4	Height	35.688 " / 906.475 mm (.906 m)
5	Weight (Standard)	6,400 lbs. / 2902.991 kilos
6	Weight (with LBT) (LBT = 625 lbs each, 1250 lbs per pair)	7,650 lbs. / 3469.982 kilos
7	Length (bonnets closed)	96.250 " / 2.445 m
8	Length (bonnets opened)	146.875 " / 3.731 m
9	Length (bonnets closed, LBT installed) (LBT ≤ 17" each, 34" pair)	≤ 130.250 " / 3.308 m
10	Length (bonnets opened, LBT installed) (LBT ≤ 17" each, 34" pair)	≤ 180.875 " / 4.594 m
11	Bonnet bolt torque (API lube)	7,900 ft.lbs. / 10,711 N'm
12	Bonnet bolt torque (Moly Lube)	4,100 ft.lbs. / 5,559 N'm
13	Bonnet bolt (impact socket size)	2-3/4 " / 69.850 mm
14	Bonnet bolt (striking wrench size)	1-3/4 " / 44.450 mm
15	Hydraulic operating pressure	1,500 PSI / 103.422 bar
16	Max hydraulic pressure	3,000 PSI / 206.844 bar
17	Open and close porting size	1" NPT
18	Open volume/Standard Bonnet per cavity	3.4 gal. / 12.870 liters
19	Close volume/Standard Bonnet per Cavity	3.5 gal. / 13.249 liters
20	Open volume (with LBT installed)	6.8 gal. / 25.741 liters
21	Close volume (with LBT installed)	12.2 gal. / 46.182 liters
22	Ram Change rod open faced wrench size	2 " / 50.800 mm
23	(2) 11" 10K Flange-Bolt Diameter x Length	1-3/4 " x 15-3/8 " / 44.450 mm x 390.525 mm
24	Quantity	16 per flange
25	Bolt Torque	2,696 ft.lbs. / 3,655.24 N'm
26	(2) 4-1/16" 10K Flanged Outlet-Bolt Diameter x Length	1-1/8 " x 8-1/2 " / 28.575 mm x 215.900 mm
27	Quantity	8 per flange
28	Bolt Torque	686 ft.lbs. / 930.08 N'm
29	Flange Gasket	BX-158
30	Outlet Gasket	BX-155

* Drawings and information contained herein are for general purposes and are for reference only. Dimensions may vary according to Manufacturer, Year Manufactured, Model or Type.

Technical information contained herein is furnished without charge or obligation and is given and accepted at recipient's sole risk. Because conditions of use may vary and are beyond our control, Patterson Services, Inc. makes no representation about, and is not responsible or liable for the accuracy or reliability of the data, described herein. Nothing contained in this document shall be considered a recommendation for any use that may infringe patent rights, or an endorsement of any particular material, equipment, service, or other item. The properties listed in this document are not specification. They are provided as information only and in no way modify, amend, enlarge or create any specification or warranty.





PATTERSON SERVICES, INC.

SPECIFICATIONS

DIMENSIONAL DATA

Cameron U BOP Single 11" 10K

Size (inches)	Pressure rating (PSI)	Vertical Bore (inches)	Single Approx. Weight (lbs)
11"	10,000	11"	6,400.00

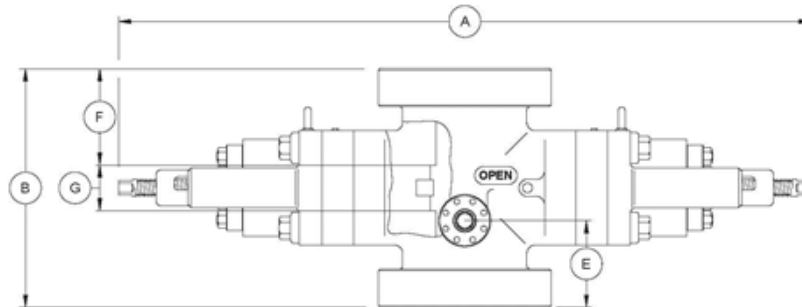
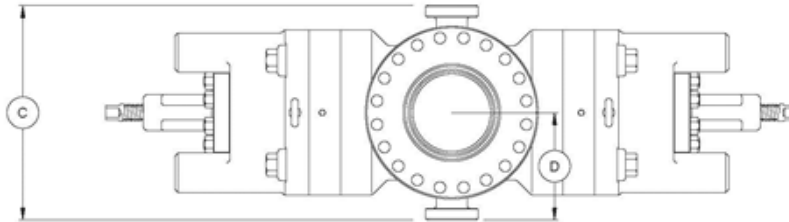

Single U BOP

The capital letters in the following designations refer to the U BOP dimensional views and dimensional charts shown.

- A-1 Length - bonnets closed, locking screws locked
- A-2 Length - bonnets opened, locking screws unlocked .
- A-3 Length - bonnets closed, with wedgelocks
- A-4 Length - bonnets opened, with wedgelocks
- B-1 Height - flanged
- B-2 Height - clamp hubs
- C Width - no side outlets
- D Centerline of preventer to outlet flange or hub face. This distance is **variable** and must be determined per individual specifications.
- E-1 Centerline of side outlet to bottom flange face
- E-2 Centerline of side outlet to bottom hub face
- F-1 Top of ram to top flange face
- F-2 Top of ram to top hub face
- G Height of ram

English Units (inches)

A-1	A-2	A-3	A-4	B-1	B-2	C	D	E-1	E-2	F-1	F-2	G	English Units (lbs) Approx. Weight (lbs)
96.250	146.875	110.125	150.188	35.688	32.188	25.750	-	13.125	11.375	13.844	12.090	6.750	6,400.000

Metric Units (m)

Metric Units (m)						Metric Units (mm)						Metric Units (kg) Approx. Weight (kg)	
A-1	A-2	A-3	A-4	B-1	B-2	C	D	E-1	E-2	F-1	F-2	G	
2.445	3.731	2.797	3.815	0.871	0.744	638.175	-	315.925	252.425	334.162	270.662	171.450	2,902.991

Tubing

1" thru 4 1/2"

Drill Pipe

2 3/8" thru 5 1/2"

Heavy Weight Drill Pipe

2 7/8" thru 6 5/8"

Drill Collars

2 7/8" thru 10"

Blow-Out Preventers

Annular Type

2 9/16" 5M thru 29 1/2" 500 PSI

Hydraulic Ram Type

Single and Double

3 1/16" 10M thru 21 3/4" 5M

Valves Manual & Hydraulic

12" Ball Valves

2 1/16" 5M thru 4 1/16" 15M