



# PATTERSON SERVICES, INC.

## BOP Information Sheet\*

## Cameron U BOP Single 11" 15K

### Tubing

1" thru 4 1/2"

### Drill Pipe

2 3/8" thru 5 1/2"

### Heavy Weight

### Drill Pipe

2 7/8" thru

6 5/8"

### Drill Collars

2 7/8" thru 10"

### Blow-Out

### Preventers

### Annular Type

2 9/16" 5M thru

29 1/2" 500 PSI

### Hydraulic Ram

### Type

### Single and Double

3 1/16" 10M thru

21 3/4" 5M

### Valves Manual &

### Hydraulic

12" Ball Valves

2 1/16" 5M thru

4 1/16" 15M

1	BOP Serial #	P-
2	Type	Type "U" Single Ram BOP 11" 15K
3	Manufacturer	Cameron
4	Height	44.812" / 1.138 m
5	Weight (Standard)	10,300 lbs. / 4,672.001 kg
6	Weight (with LBT) (LBT ≤ 840 lbs each, 1,680 lbs per pair)	11,980 lbs. / 5,434.037 kg
7	Length (bonnets closed)	124.000" / 3.150 m
8	Length (bonnets opened)	175.312" / 4.453 m
9	Length (bonnets closed, LBT installed) (LBT ≤ 19.75", 39.50" per pair)	163.500" / 4.1535 m
10	Length (bonnets opened, LBT installed) (LBT ≤ 19.75", 39.50" per pair)	214.812" / 5.456 m
11	Bonnet bolt torque (API lube)	14,500 ft.lbs./ 19,659 N'm
12	Bonnet bolt torque (Moly Lube)	7,500 ft.lbs./10,168 N'm
13	Bonnet bolt (impact socket size)	3-1/2" / 88.900 mm
14	Bonnet bolt (striking wrench size)	2-1/4" / 57.150 mm
15	Hydraulic operating pressure	1,500 PSI / 103.422 bar
16	Max hydraulic pressure	3,000 PSI / 206.844 bar
17	Open and close porting size	1" NPT
18	Open volume (standard bonnet per cavity)	5.7 gal. / 21.577 liters
19	Close volume (standard bonnet per cavity)	5.8 gal. / 21.955 liters
20	Open volume (with LBT installed)	8.9 gal. / 33.690 liters
21	Close volume (with LBT installed)	15.6 gal. / 59.052 liters
22	Ram Change rod open faced wrench size	2-1/4" / 57.150 mm
23	(2) 11" 15K Flange-Bolt Diameter x Length	2" x 19-1/2" / 50.800 mm x 495.300 mm
24	Quantity	20 per flange
25	Bolt Torque	4,061 ft.lbs. / 5,506 N'm
26	(2) 4-1/16" 15K Flanged Outlet-Bolt Diameter x Length	1-3/8" x 9-3/4" / 34.925 mm x 247.650 mm
27	Quantity	8 per flange
28	Bolt Torque	1,281 ft.lbs. / 1,737 N'm
29	Flange Gasket	BX-158
30	Outlet Gasket	BX-155

\* Drawings and information contained herein are for general purposes and are for reference only. Dimensions may vary according to Manufacturer, Year Manufactured, Model or Type.

Technical information contained herein is furnished without charge or obligation and is given and accepted at recipient's sole risk. Because conditions of use may vary and are beyond our control, Patterson Services, Inc. makes no representation about, and is not responsible or liable for the accuracy or reliability of the data, described herein. Nothing contained in this document shall be considered a recommendation for any use that may infringe patent rights, or an endorsement of any particular material, equipment, service, or other item. The properties listed in this document are not specification. They are provided as information only and in no way modify, amend, enlarge or create any specification or warranty.





# PATTERSON SERVICES, INC.

## SPECIFICATIONS

### DIMENSIONAL DATA

Cameron U BOP Single 11" 15K

Size (inches)	Pressure rating (PSI)	Vertical Bore (inches)	Single Approx. Weight (lbs)
11"	15,000	11"	10,300.00

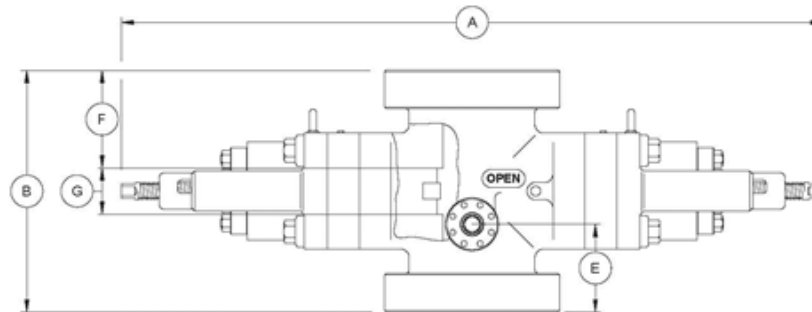
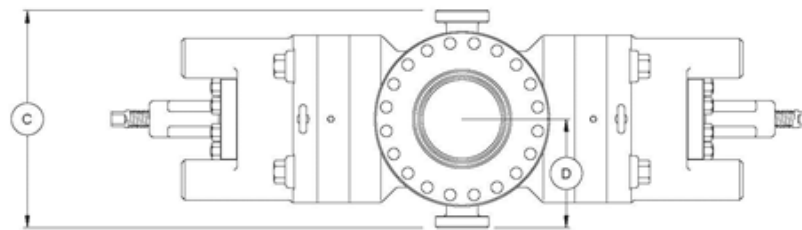

Single U BOP

The capital letters in the following designations refer to the U BOP dimensional views and dimensional charts shown.

- A-1 Length - bonnets closed, locking screws locked
- A-2 Length - bonnets opened, locking screws unlocked.
- A-3 Length - bonnets closed, with wedgelocks
- A-4 Length - bonnets opened, with wedgelocks
- B-1 Height - flanged
- B-2 Height - clamp hubs
- C Width - no side outlets
- D Centerline of preventer to outlet flange or hub face. This distance is **variable** and must be determined per individual specifications.
- E-1 Centerline of side outlet to bottom flange face
- E-2 Centerline of side outlet to bottom hub face
- F-1 Top of ram to top flange face
- F-2 Top of ram to top hub face
- G Height of ram

English Units (inches)

A-1	A-2	A-3	A-4	B-1	B-2	C	D	E-1	E-2	F-1	F-2	G	English Units (lbs) Approx. Weight (lbs)
124.000	175.312	124.500	167.125	44.812	33.875	32.000	_	16.688	11.219	17.781	12.312	9.250	10,300.000

Metric Units (m)

A-1	A-2	A-3	A-4	B-1	B-2	C	D	E-1	E-2	F-1	F-2	G	Metric Units (kg) Approx. Weight (kg)
3.150	4.453	3.162	4.245	1.138	0.860	812.800	_	423.875	284.963	451.637	312.725	234.950	4,672.001

#### Tubing

1" thru 4 1/2"

#### Drill Pipe

2 3/8" thru 5 1/2"

#### Heavy Weight Drill Pipe

2 7/8" thru 6 5/8"

#### Drill Collars

2 7/8" thru 10"

#### Blow-Out Preventers

##### Annular Type

2 9/16" 5M thru 29 1/2" 500 PSI

##### Hydraulic Ram Type

##### Single and Double

3 1/16" 10M thru 21 3/4" 5M

#### Valves Manual & Hydraulic

##### 12" Ball Valves

2 1/16" 5M thru 4 1/16" 15M